

## Patient Instructions

# Chlamydia/Gonococci or Mycoplasma genitalium

## Urine Sample

### THIS IS WHAT YOU NEED

Disposable plastic cup. Testing kit given to you by your care provider. The liquid in the tube is not dangerous if used normally. If you get it on your skin, rinse with plenty of water.

### HOW TO DO IT



At least one hour must have elapsed since you peed before you take the sample.

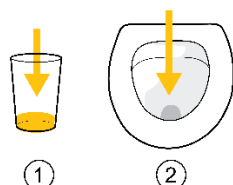

- 1) Pee the first bit of urine, around a quarter of a decilitre, into a clean cup.
- 2) Pee the rest into the toilet.

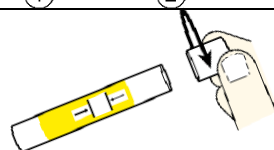

Unscrew the lid of the tube without destroying the foil on the lid. The liquid should remain in the tube.

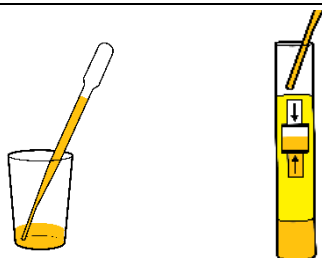

Use the pipette to suck up urine from the cup.

Use the pipette to transfer urine to the tube so that the level is **between the arrows** on the tube's window.

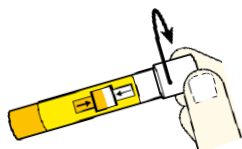

Carefully screw the lid back on to the tube.



Label the **tube** with your full personal identity number and name, and the date and time at which the sample was taken. Use the label given to you by your care provider.

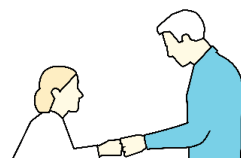

Hand in the sample to your care provider on the same day as the sample was taken at the latest. Transport the sample in a plastic bag of ice. Bring valid ID.